

POCKET DOOR EZ-CLOSER INSTALLATION INSTRUCTIONS

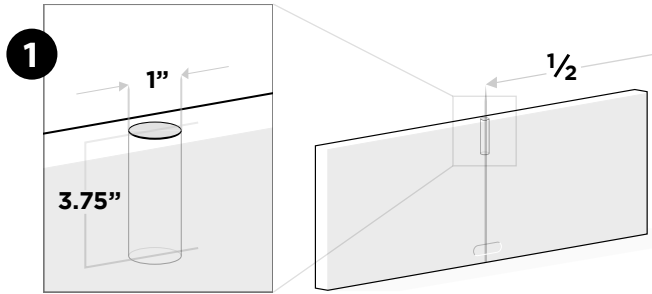

Flush Doors: With the door dismounted, measure and find the **centre on the back edge of the door**.

IMPORTANT: For doors with glass, molded passages or any other non-flush door you might need to off-set the location of the hole for installation of the *EZ-Closer*. Before drilling ensure that there is sufficient width and depth to drill a 1.0 inch wide hole 3.75 inches deep without damaging the door. See installation tips 1 and 2, below.

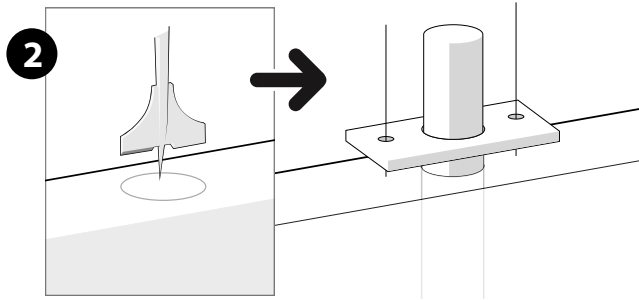

Using a **1 inch spade bit**, bore a hole to the depth of **3.75 inches** (the length of the *EZ-Closer* cylinder). Firmly push the *EZ-Closer* into the drilled hole and secure with the two screws provided (screws must be counter sunk). Now your door is ready to be fitted.

The *EZ-Closer* should sit on the back edge of the door. **DO NOT** mortise the flange into the back of the door.

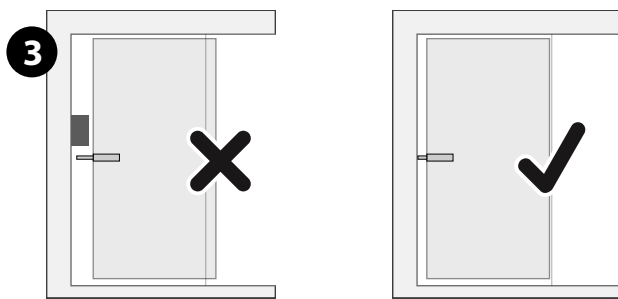

Ensure that there is **no object between the back of the door** and the back stud inside the pocket, which would prohibit the plunger on the *EZ-Closer* from being fully depressed (see diagram). The pocket back stud and back edge of door must be plumb allowing the gap between door and back stud to be parallel.

Failure to do this could affect the smooth and positive feel of the *Jexis* action. Pocket Doors with the *EZ-Closer* installed **do not need the bumper** (remove the bumper at the end of cavity if already installed).

PHYSICAL SPECIFICATIONS

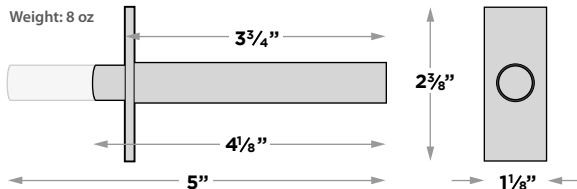

INSTALLATION TIPS

- 1) For smooth operation do not install the *EZ-Closer* near the top or bottom edge of the door. The door must NOT tilt when pushed to release from the cavity.
- 2) For non-flush doors an alternative installation option is to install the *EZ-Closer* in the pocket back stud.
- 3) If the door is slightly undersize in relation to the pocket: place enough washers (packers) between the *EZ-Closer* faceplate and the back edge of the door, until the front edge of the door is flush with the opening Jamb.

MANUFACTURER'S LIMITED WARRANTY

PC Doors, LLC is an authorized distributor of the *Jexis Cavity Release* ("*EZ-Closer*") and all *EZ-Closers* are covered by the following Manufacturer's Limited Warranty:

Manufacturer's Warranty

Jexis Cavity Release is warranted to be of good quality, workmanship and material, free from defects which would render them unserviceable or unfit within 5 years of purchase. Invenco Limited agrees to repair or replace at its option any *Jexis* found to be defective in the meaning of the warranty.

The *Jexis Cavity Release* must be installed according to the written instructions provided at time of sale. Failure to do so voids this warranty.

Replacement does not extend to or include liability for any punitive or exemplars damages or for work such as replacement / repair labor, painting, re-glazing or other consequential loss.

Please contact the Manufacturer with any warranty requests:

Mail: Invenco, C/O PC Doors, LLC, 101 Pacifica, suite 200, Irvine, CA 92618
Phone: (949) 468-0178

Limitations:

Neither PC Doors, LLC nor the Manufacturer shall have any liability with respect to any product which is not installed in accordance with the written instructions provided on this Site. All warranties will be voided if abuse or improper use is suspected.

EXCEPT AS SPECIFIED IN THIS WARRANTY SECTION, ALL EXPRESS OR IMPLIED CONDITIONS, REPRESENTATIONS, AND WARRANTIES INCLUDING, WITHOUT LIMITATION, ANY IMPLIED WARRANTY OR CONDITION OF MERCHANTABILITY, FITNESS FOR A PARTICULAR PURPOSE, OR SATISFACTORY QUALITY, ARE HEREBY EXCLUDED TO THE EXTENT ALLOWED BY APPLICABLE LAW AND ARE EXPRESSLY DISCLAIMED BY PC DOORS, LLC AND MANUFACTURER. TO THE EXTENT AN IMPLIED WARRANTY CANNOT BE EXCLUDED, SUCH WARRANTY IS LIMITED IN DURATION TO THE EXPRESS WARRANTY PERIOD.

NEITHER PC DOORS, LLC NOR MANUFACTURER SHALL BE LIABLE FOR ANY DIRECT, SPECIAL, INCIDENTAL, INDIRECT OR CONSEQUENTIAL DAMAGES THAT RESULT FROM THE USE OF, OR THE INABILITY TO USE, THE PRODUCTS PURCHASED THROUGH THIS WEBSITE OR OTHERWISE FROM PC DOORS, LLC, EVEN IF PC DOORS, LLC HAS BEEN ADVISED OF THE POSSIBILITY OF SUCH DAMAGES. OTHER THAN THE MANUFACTURER'S LIMITED WARRANTY, YOU ASSUME TOTAL RESPONSIBILITY FOR YOUR USE OF THE *EZ-CLOSER*.